

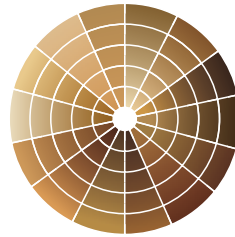

WOODWORKS®  
ACGI  
Species &  
Stains

# Specify the PERFECT Wood Species + Stain

To make the selection process easier, we've put together this guide that shows our standard wood veneers, solids, and finishes. Don't see exactly what you're looking for? Any commercially available solid wood or veneer can be sourced. In addition to our standard finishes, we can create or coordinate any color to meet your project's requirements.



## FSC® CERTIFIED

Additional lead time is required for species with FSC® certification.

Veneer species are more readily available in FSC certified flitches.



The mark of  
responsible forestry

## Celebrate the Natural Beauty

WoodWorks® ACGI Custom Capabilities; ►  
Temple University Charles Library,  
Philadelphia, PA









▲ WoodWorks® ACGI Grille; Temple Tifereth Isreal, Beachwood OH



## VENEER MATCHING EXPLAINED

### BOOK MATCH

One method of matching a veneer is book match. This is accomplished by opening consecutive veneer layers as if opening a book. It creates a symmetrical pattern that effectively displays a wood's grain. It is best used with a plain sliced veneer.

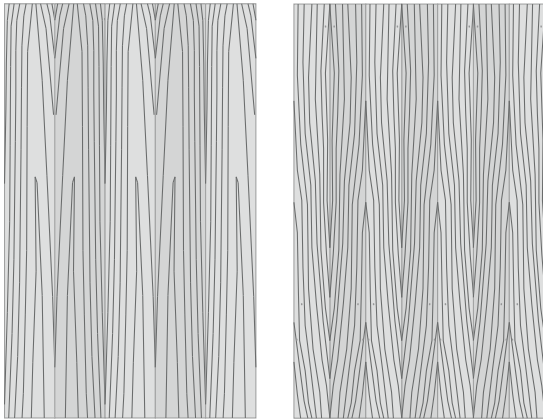

### SLIP MATCH

Another method of matching veneer is slip match. This is accomplished when stacked layers of veneer are “slipped” across each other and laid side-by-side. This creates a linear pattern and is commonly used in most wall panels.

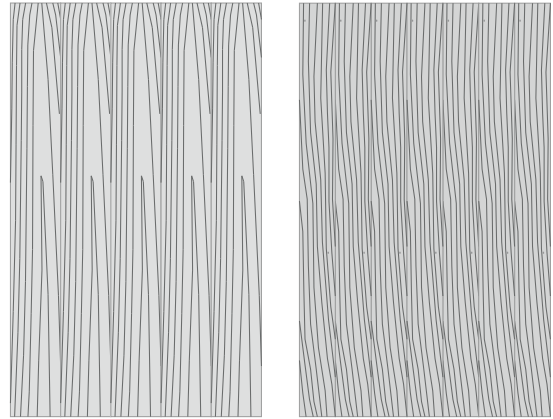

### RANDOM MATCH

Random matching is just what it sounds like. Usually done with lower grades of veneer, the leaves may be of varying width, colors, and grains.

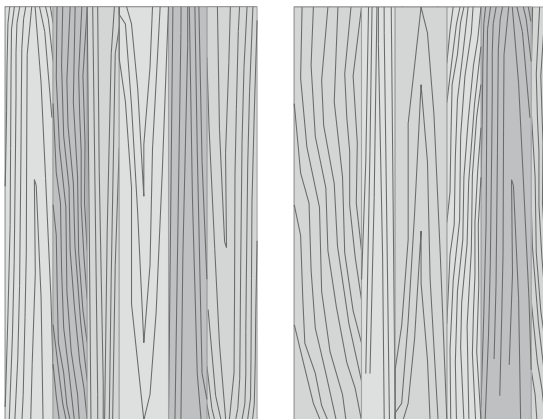

# WOOD VENEER SPECIES

## Afromosia – Beech

*We can manufacture  
your project with  
any commercially  
available wood*



**Alder**  
quarter cut



**Anigre**  
plain sliced



**Anigre**  
quarter cut



**Ash**  
plain sliced



**Ash**  
quarter cut



**Beech**  
plain sliced



**Beech**  
quarter cut

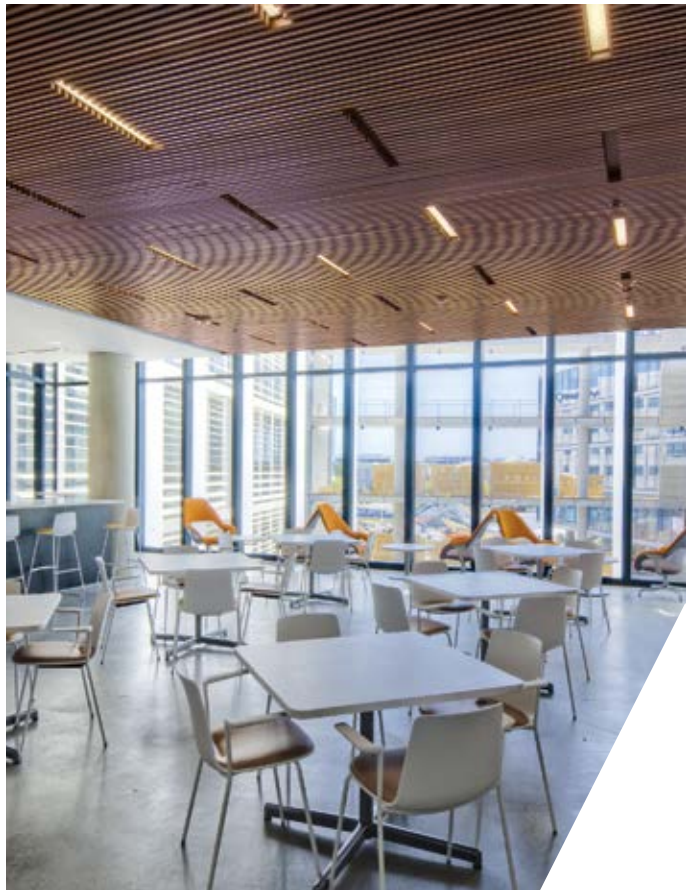

▲ WoodWorks® ACGI Grille; Qualcomm Pacific Center Campus, San Diego, CA

**NOTE:** These color samples are reproduced by a printing process so the colors represented may not match the wood's actual color. In addition, since no two trees are identical, wood can be expected to differ both in color and graining. This is what makes wood so beautiful. Stained sample will be provided for approval before project goes into production.

# WOOD VENEER SPECIES

## Cherry – Maple

*We can manufacture  
your project with  
any commercially  
available wood*



**Cherry**  
plain sliced



**Cherry**  
quarter cut



**Cherry**  
reconstituted



**Douglas Fir**  
vertical grain



**Eucalyptus**  
quarter cut, figured



**Hickory**  
plain sliced



**Mahogany (African)**  
quarter cut



**Makore**  
plain sliced



**Makore**  
quarter cut



**Maple**  
plain sliced

**NOTE:** These color samples are reproduced by a printing process so the colors represented may not match the wood's actual color. In addition, since no two trees are identical, wood can be expected to differ both in color and graining. This is what makes wood so beautiful. Stained sample will be provided for approval before project goes into production.

# WOOD VENEER SPECIES

## Maple – Walnut

*We can manufacture  
your project with  
any commercially  
available wood*



**Maple**  
quarter cut



**Oak (Red)**  
plain sliced



**Oak (Red)**  
Rift Cut



**Oak (White)**  
plain sliced



**Oak (White)**  
rift cut



**Poplar**  
plain sliced



**Sapele**  
quarter cut



**Teak**  
plain sliced



**Walnut**  
plain sliced



**Walnut**  
quarter cut



▲ WoodWorks® Allegro™ panels; Farmington Hills City Hall,  
Farmington Hills MI

**NOTE:** These color samples are reproduced by a printing process so the colors represented may not match the wood's actual color. In addition, since no two trees are identical, wood can be expected to differ both in color and graining. This is what makes wood so beautiful. Stained sample will be provided for approval before project goes into production.





▲ WoodWorks® ACGI beams and WoodWorks® ACGI Encore Acoustical panels; Temple University, Philadelphia PA

# SOLID WOOD SPECIES

## Ash – Douglas Fir

*We can manufacture  
your project with  
any commercially  
available wood*



**Ash**  
flat cut



**Ash**  
quarter cut



**Beech (Euro Steamed)**  
flat cut



**Beech (Euro Steamed)**  
quarter cut



**Birch**  
flat cut



**Cedar (Western Red)**  
flat cut



**Cedar (Western Red)**  
vertical grain



**Cherry**  
flat cut



**Cherry**  
quarter cut



**Cypress**  
flat cut



**Douglas Fir**  
vertical grain



**Douglas Fir**  
mixed grain

**NOTE:** These color samples are reproduced by a printing process so the colors represented may not match the wood's actual color. In addition, since no two trees are identical, wood can be expected to differ both in color and graining. This is what makes wood so beautiful. Stained sample will be provided for approval before project goes into production.



# SOLID WOOD SPECIES

## Eucalyptus – Walnut

*We can manufacture  
your project with  
any commercially  
available wood*



**Eucalyptus**  
flat cut



**Hemlock**  
flat cut



**Hemlock**  
vertical grain



**Mahogany (African)**  
quarter cut



**Maple**  
flat cut



**Oak (White)**  
quarter cut



**Oak (White)**  
rift cut



**Oak (Red)**  
flat cut



**Oak (Red)**  
rift cut



**Poplar**  
flat cut



**Walnut**  
flat cut



**Walnut**  
quarter cut

**NOTE:** These color samples are reproduced by a printing process so the colors represented may not match the wood's actual color. In addition, since no two trees are identical, wood can be expected to differ both in color and graining. This is what makes wood so beautiful. Stained sample will be provided for approval before project goes into production.

# STANDARD STAINS

## Ash (Veneer)

*Custom color  
tinting and  
matching  
available.*



FN101



FN102



FN103



FN104



FN105



FN106



FN107



FN108



FN109



FN110



FN111



FN112

**NOTE:** These color samples are reproduced by a printing process so the colors represented may not match the wood's actual color. In addition, since no two trees are identical, wood can be expected to differ both in color and graining. This is what makes wood so beautiful. Stained sample will be provided for approval before project goes into production.



# STANDARD STAINS

## Beech (Veneer)

*Custom color tinting and matching available.*



FN101



FN102



FN103



FN104



FN105



FN106



FN107



FN108



FN109



FN110



FN111



FN112

**NOTE:** These color samples are reproduced by a printing process so the colors represented may not match the wood's actual color. In addition, since no two trees are identical, wood can be expected to differ both in color and graining. This is what makes wood so beautiful. Stained sample will be provided for approval before project goes into production.

# STANDARD STAINS

## Birch (Veneer)

*Custom color  
tinting and  
matching  
available.*



FN101



FN102

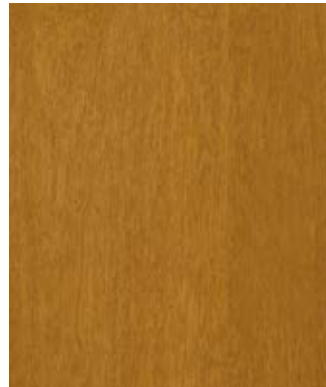

FN103



FN104



FN105



FN106



FN107



FN108



FN109



FN110



FN111



FN112

**NOTE:** These color samples are reproduced by a printing process so the colors represented may not match the wood's actual color. In addition, since no two trees are identical, wood can be expected to differ both in color and graining. This is what makes wood so beautiful. Stained sample will be provided for approval before project goes into production.



# STANDARD STAINS

## Cherry (Veneer)

*Custom color  
tinting and  
matching  
available.*



FN101



FN102



FN103



FN104



FN105



FN106



FN107



FN108



FN109



FN110



FN111



FN112

**NOTE:** These color samples are reproduced by a printing process so the colors represented may not match the wood's actual color. In addition, since no two trees are identical, wood can be expected to differ both in color and graining. This is what makes wood so beautiful. Stained sample will be provided for approval before project goes into production.

# STANDARD STAINS

## Cypress (Solid)

*Custom color  
tinting and  
matching  
available.*



FN101



FN102



FN103



FN104



FN105



FN106



FN107

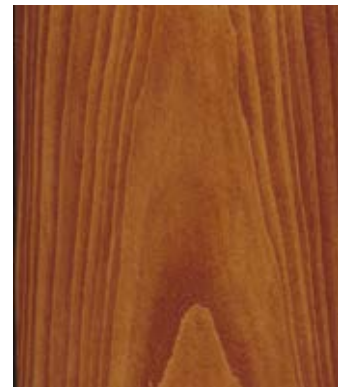

FN108



FN109



FN110



FN111



FN112

**NOTE:** These color samples are reproduced by a printing process so the colors represented may not match the wood's actual color. In addition, since no two trees are identical, wood can be expected to differ both in color and graining. This is what makes wood so beautiful. Stained sample will be provided for approval before project goes into production.



# STANDARD STAINS

## Douglas Fir (Solid)

Custom color  
tinting and  
matching  
available.



FN101



FN102



FN103



FN104



FN105



FN106



FN107



FN108



FN109



FN110



FN111



FN112

**NOTE:** These color samples are reproduced by a printing process so the colors represented may not match the wood's actual color. In addition, since no two trees are identical, wood can be expected to differ both in color and graining. This is what makes wood so beautiful. Stained sample will be provided for approval before project goes into production.

# STANDARD STAINS

## Hemlock (Solid)

*Custom color  
tinting and  
matching  
available.*



FN101



FN102



FN103



FN104



FN105



FN106



FN107



FN108

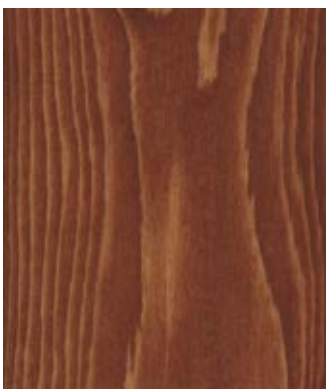

FN109

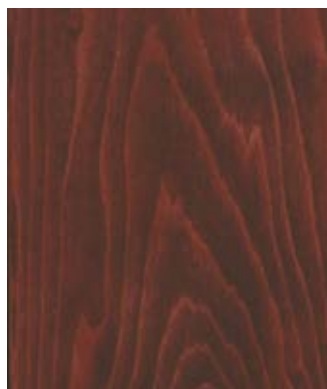

FN110



FN111



FN112

**NOTE:** These color samples are reproduced by a printing process so the colors represented may not match the wood's actual color. In addition, since no two trees are identical, wood can be expected to differ both in color and graining. This is what makes wood so beautiful. Stained sample will be provided for approval before project goes into production.



# STANDARD STAINS

## Maple (Veneer)

*Custom color  
tinting and  
matching  
available.*



FN101



FN102



FN103



FN104



FN105



FN106



FN107



FN108



FN109



FN110



FN111



FN112

**NOTE:** These color samples are reproduced by a printing process so the colors represented may not match the wood's actual color. In addition, since no two trees are identical, wood can be expected to differ both in color and graining. This is what makes wood so beautiful. Stained sample will be provided for approval before project goes into production.

# STANDARD STAINS

## Oak (Veneer)

*Custom color  
tinting and  
matching  
available.*



FN101



FN102



FN103



FN104



FN105



FN106



FN107



FN108

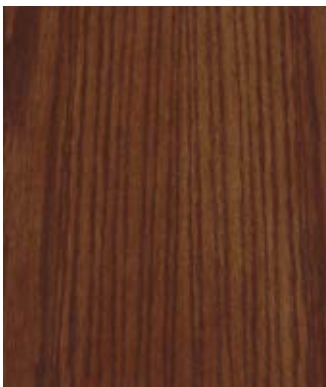

FN109



FN110



FN111



FN112

**NOTE:** These color samples are reproduced by a printing process so the colors represented may not match the wood's actual color. In addition, since no two trees are identical, wood can be expected to differ both in color and graining. This is what makes wood so beautiful. Stained sample will be provided for approval before project goes into production.



# STANDARD STAINS

## Poplar (Solid)

*Custom color tinting and matching available.*



FN101



FN102



FN103



FN104



FN105



FN106



FN107



FN108



FN109



FN110



FN111



FN112

**NOTE:** These color samples are reproduced by a printing process so the colors represented may not match the wood's actual color. In addition, since no two trees are identical, wood can be expected to differ both in color and graining. This is what makes wood so beautiful. Stained sample will be provided for approval before project goes into production.

# STANDARD STAINS

## Walnut (Veneer)

*Custom color tinting and matching available.*



FN101



FN102



FN103



FN104



FN105



FN106



FN107



FN108



FN109



FN110



FN111



FN112

**NOTE:** These color samples are reproduced by a printing process so the colors represented may not match the wood's actual color. In addition, since no two trees are identical, wood can be expected to differ both in color and graining. This is what makes wood so beautiful. Stained sample will be provided for approval before project goes into production.





▲ WoodWorks® ACGL Linear ceiling system; FMC Tower at Cira Centre South, Philadelphia, PA

# TAKE THE NEXT STEP

## 1 877 276-7876

Customer Service Representatives  
7:45 a.m. to 5:00 p.m. EST  
Monday through Friday

**TechLine** – Technical information, detail drawings,  
CAD design assistance, installation information,  
other technical services – 8:00 a.m. to 5:30 p.m. EST,  
Monday through Friday. FAX 1 800 572 8324  
or email: [techline@armstrongceilings.com](mailto:techline@armstrongceilings.com)

## [armstrongceilings.com/commercial](http://armstrongceilings.com/commercial)

Latest product news  
Standard and custom product information  
Online catalog  
CAD, Revit®, SketchUp® files  
A Ceiling for Every Space® Visual Selection Tool  
Product literature and samples – express service  
or regular delivery  
Contacts – reps, where to buy, who will install

## YOU INSPIRE™ SOLUTIONS CENTER

email: [solutionscenter@armstrongceilings.com](mailto:solutionscenter@armstrongceilings.com)  
[armstrongceilings.com/youinspire](http://armstrongceilings.com/youinspire)

### Design Assistance

Collaborative design  
Detail drawings  
Specifications  
Planning and budgeting

### Pre-construction Assistance

Layout drawings for standard  
and premium products  
Project installation recommendations  
Contractor installation assistance

**you inspire™**  
solutions center

helping to bring your one-of-a-kind ideas to life

Revit® is a registered trademark of Autodesk, Inc.; SketchUp® is a registered trademark of Trimble, Inc.; FSC® is a registered trademark of FSC Forest Stewardship Council®  
All other trademarks used herein are the property of AWI Licensing LLC and/or its affiliates  
© 2022 AWI Licensing LLC Printed in the United States of America

[armstrongceilings.com/acgiwood](http://armstrongceilings.com/acgiwood)

**Armstrong®**  
CEILING & WALL SOLUTIONS