

new ACOUSTIBUILT®

Seamless Acoustical Ceiling and Wall System
fine texture



CAD/Revit® drawings at:
armstrongceilings.com/cadrevit

AcoustiBuilt® Seamless Acoustical Ceiling System

Wall system available



AcoustiBuilt Ceiling System in Black Fine-Texture Finish

New seamless acoustical ceiling and wall system that looks like drywall, but offers Total Acoustics® performance.

KEY SELECTION ATTRIBUTES

- new** The look of drywall in a seamless acoustical ceiling and wall system (install on walls above 7 feet to prevent damage)
- Get total noise control and floor plan versatility with Total Acoustics® ceiling panel options: NRC + CAC = Total Acoustics performance
- Finished AcoustiBuilt® panels are part of the Sustain® portfolio and meet the most stringent industry sustainability compliance standards today
- Smooth non-directional, monolithic, drywall-like visual
- new** Custom colors available to meet your design palette

- AcoustiBuilt® is intended for spaces desiring a Level 4 equivalent drywall finish
- Install on FrameAll™ Drywall Grid, in any room, any size – flat or sloped
- Similar installation and finishing methods to drywall ceilings
- CleanAssure™ family of products – includes disinfectable panels, suspension systems, and trim
- Mold- and mildew-resistant surface
- Use Drywall Grid SimpleSoffit® framing system for faster, easier soffit construction
- new** Use AcoustiBuilt® system for open-air plenum applications
- Easier to install than acoustical plaster at a lower cost
- Can be installed with most drywall-compatible light fixtures including those from our partners:
 - Axis
 - XAL
 - USAI®
 - Price®
- Improves STC of interior stud/drywall partition systems by up to 6 points
- Seamless integration with VidaShield UV24™ Air Purification System
- Made in the U.S.A. of domestic and global content
- Build America, Buy America Act (BABAA) compliant

TYPICAL APPLICATIONS

- Offices
- Lobbies
- Education
- Exposed Structure
- Retail
- Hospitality
- Cloud Applications

FINE-TEXTURE FINISH FOR ACOUSTIBUILT PANELS

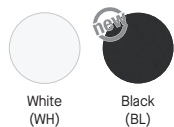

CUSTOM COLORS AVAILABLE



Available in any color!

NOTE: Custom AcoustiBuilt fine-texture finish colors will appear one or two shades darker than a standard paint color sample when applied due to the texture in the finish.

ACOUSTIBUILT®
Seamless Acoustical Ceiling
and Wall System
fine texture



LEED® WELL | LBC

UP TO **70% RECYCLED CONTENT**

Calculate sustainability with Ecomedes
armstrongceilings.com/ecomedes

energy management
construction waste mgmt
regional materials
design for flexibility
EPD
recyclable/producer resp.
biobased materials
recycled content
sourcing of raw materials
material ingredient reporting
low emitting materials
lighting quality
acoustics

LOCATION DEPENDENT

VISUAL SELECTION

Item No.	Dimensions (Inches)
ACOUSTIBUILT® Ceiling and Wall Panels	2604 48 × 72 × 7/8"

7/8" Tapered Edge on 4 Sides

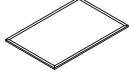

PERFORMANCE SELECTION Dots represent high level of performance (panel and grid).

NRC	CAC	Total Acoustics ¹	Fire Performance	Light Reflect	Anti-Mold/Mildew	Sag Resistant	Certified Low VOC Emissions	CleanAssure™ Disinfectable Panels	DURABILITY	Recycle Program	10-Yr Warranty
0.80*	46	BEST	Class A	0.87**				Fog Spray Wash Scratch Soil	N/A N/A N/A N/A		

¹ Total Acoustics® ceiling panels have an ideal combination of sound absorption and sound blocking in one product.
* Per ASTM C423 & E795, E-400 mounting.
** White fine-texture finish panel performance following the installation instructions.

WALL-TO-WALL ASSEMBLY AND INSTALLATION OVERVIEW

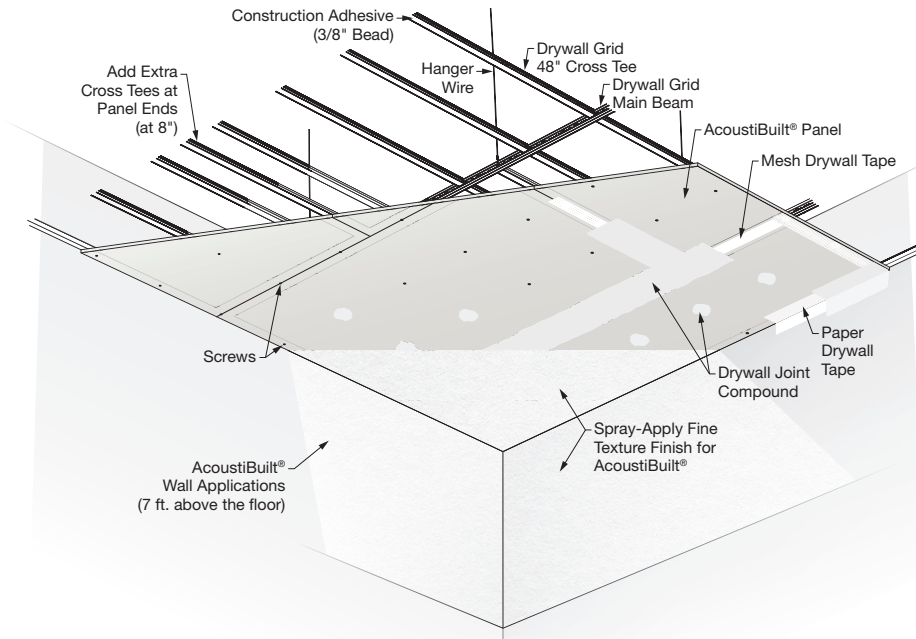

ACOUSTICAL INFORMATION

Mounting Method	Sabins/SF
Cloud	0.80
Cloud w/ infill 8200T10	1.33
STC Rating***	
1 Side	42
2 Sides	43

*** 3-5/8" metal studs with one layer of 5/8" drywall on both sides and AcoustiBuilt Panels on one or both sides.

PHYSICAL DATA

Material
Wet-formed mineral fiber.

Fire Performance
Class A: ASTM E84 and CAN/ULC S102 surface burning characteristics. Flame Spread of 25 or less. Smoke Developed of 50 or less.

ASTM E1264 Classification
Type A5, Form 2, Pattern E
Fire Class A

Humidity/Sag Resistance
HumiGuard® Plus ceiling panels are recommended for areas subject to high humidity, up to, but not including, standing water and outdoor applications.

Anti-Mold/Mildew
Ceiling panels with BioBlock® performance resist the growth of mold and mildew on the panel surface.

High Recycled Content
Contains greater than 50% total recycled content. Total recycled content based on product composition of post-consumer and pre-consumer (post-industrial) recycled content per FTC guidelines.

VOC Emissions
Third-party certified compliant with California Department of Public Health CDPH/EHLB/Standard Method Version 1.2, 2017. This standard is the guideline for low emissions in LEED®, WELL Building Standard®, Living Building Challenge® (LBC), CalGreen Title 24, ANSI/ASHRAE/USGBC/IES Standard 189; ANSI/GBI Green Building Assessment Protocol.

Design and Lighting Considerations
AcoustiBuilt® panels are intended for spaces desiring a Level 4 equivalent drywall finish. Like Level 4 drywall, critical or low-angle light grazing across the ceiling can show imperfections. Special attention to finishing and sanding may be required. Downlights can complement the appearance in severe grazing light.

Installation is similar to standard wallboard and drywall suspension systems. However, it requires more precision and a higher level of finish to achieve an acceptable appearance. Lighting conditions can magnify surface imperfections, especially natural light that shines from oblique angles. It is strongly recommended that a job site mockup be constructed with representative lighting so that expectations regarding the finished appearance are managed.

Lighting and diffuser fixtures must be able to accommodate 7/8" thick panels. Contact the lighting and diffuser manufacturers for recommended fixture use and integration. AcoustiBuilt is a non-accessible ceiling. Access panels can be integrated, as needed, following standard installation practices. Refer to access panel manufacturer to verify compatibility with 7/8" thick panels.

Acoustical Considerations
When installed as a cloud, average sound absorption is 0.80 Sabins/SF. The addition of acoustical infill panel Item 8200T10 can increase sound absorption up to 1.33 Sabins/SF. Excessive integrations and/or small enclosed spaces where the ceiling is more compound than open area will result in degradation of sound absorption. Certain lighting conditions and/or colors may require an additional coat of fine-texture finish, resulting in a degradation of sound absorption. AcoustiBuilt panels absorb the most sound when installed as full panels. Plan the layout to minimize panel joints and fixture integrations which cover the surface of the ceiling.

Insulation Value
R Factor - 2.2 (BTU Units)
R Factor - 0.39 (Watts Units)

Cleaning and Disinfecting
Cleaning and CDC-recommended disinfecting options available on armstrongceilings.com/cleaning

10-Year Panel Warranty
Details at armstrongceilings.com/acoustibuilt

Weight; Square Feet/Carton
2604 - 1.1 lbs/SF; 240 SF/ctn

Minimum Order Quantity
1 carton (10pcs)

ACOUSTIBUILT®

Seamless Acoustical Ceiling and Wall System
fine texture



LEED WELL LBC UP TO 70% RECYCLED CONTENT

energy management, construction waste mgmt, regional materials, design for flexibility, EPD, recyclable/extended producer resp., biobased materials, recycled content, sourcing of raw materials, material ingredient reporting, low emitting materials, lighting quality, acoustics

Calculate sustainability with Ecomedes
armstrongceilings.com/ecomedes

LOCATION DEPENDENT

SUSPENSION SYSTEMS – Order Separately

Item No.	Description	Required for Install	Qty/Ctn
HD8906	12' HD Drywall Main Beam	Yes	12/144
XL8945P	4' Drywall Cross Tee	Based on layout	36/144
KAM21020	2 x 2 x 120" Knurled Angle Molding (0.033" metal thickness)	Based on layout	10/100
SSLU2424	SimpleSoffit® L Soffit Upturn 6-1/2 x 1-3/4 x 48-1/2"	N/A	12/48
7891	12-gauge hanger wires 144" length	N/A	140 pcs

PERIMETER TRIM OPTIONS – Order Separately

Item No.	Description	Required for Install
AX1PC_STR AX1PC_CUR	Axiom® One-Piece Drywall Trim available for 4" and 6" heights – straight or curved	Based on layout
AX_STR AX_CUR	Axiom Classic Trim available in 2" to 16" heights (2" increments – straight or curved) with Axiom Bottom Trim for AcoustiBuilt®	Based on layout
AXBTASTR AXBTACUR	Axiom Bottom Trim	Axiom Bottom Trim is required to use Axiom Classic and select Axiom Trims with AcoustiBuilt
AXAKEACBSTR AXAKEACBIC AXAKEACBOC	Axiom® Angled Knife Edge® Trim for AcoustiBuilt – Inside or Outside Corner	Based on layout
ARM625500STR	1/2" Wall reveal from 7/8" AcoustiBuilt to 5/8" Drywall	Based on layout

ACOUSTIBUILT FINE-TEXTURE FINISH PAINT – Order Separately

Item No.	Description	Required for Install
2605WH (White) 2605BL (Black)	Fine-texture finish for AcoustiBuilt Panels (available in White, Black, and custom colors)	For every 10 panels (240 SF) – order 1 pail (4 gal.) 200 SF on custom color applications

CASTWORKS™ GFRG ACCESS PANELS FOR ACOUSTIBUILT

Item No.*	Description
AS0300S02T7G0CPG AS0300S04T7G0CPG AS0300S05T7G0CPG	12 x 12 x 7/8" Squared Corners Lay-in 18 x 18 x 7/8" Squared Corners Lay-in 24 x 24 x 7/8" Squared Corners Lay-in
AS0300R02T7G0CPG AS0300R04T7G0CPG AS0300R05T7G0CPG	12 x 12 x 7/8" Rounded Corners Lay-in 18 x 18 x 7/8" Rounded Corners Lay-in 24 x 24 x 7/8" Rounded Corners Lay-in

See more Access Panel options at: armstrongceilings.com/castworksaccesspanels
* CastWorks access panels are designed for seamless integration with AcoustiBuilt panels as frames are 7/8" thick.

ACCESSORIES BY OTHERS – Order Separately

Item No.	Description
Screws	# 6 x 1-5/8" fine thread, corrosion-resistant drywall screws # 6 x 1-5/8" coarse thread drywall screws (used for wall installations)
Setting-Type Compound	Fast-setting compound (hot mud)
Adhesive (Required for all ceiling and wall installations.)	Requires approx. seven 28-oz. tubes of adhesive per 240 SF.

Item No.	Description
Drying-Type Compound	All-purpose joint compound Lightweight compound
Tape	Self-adhesive mesh drywall joint tape (for panel joints) FibaFuse® drywall joint tape (use with automatic finishing tools)
Paper Tape	Paper drywall tape (for corners)

ACOUSTIBUILT® CEILING AND WALL SYSTEM



new ACOUSTIBUILT®

Seamless Acoustical Ceiling and Wall System
fine texture

USDA
CERTIFIED
BIOBASED
PRODUCT
PRODUCT 95%

SUSTAIN®
High Performance
Sustainable Ceiling Systems
Declare.

LEED® WELL | LBC

UP TO 70% RECYCLED CONTENT

- energy management
- construction waste mgmt
- regional materials
- design for flexibility
- EPD
- recyclable/producer resp.

Calculate sustainability with Ecomedes
armstrongceilings.com/ecomedes

- biobased materials
- recycled content
- sourcing of raw materials
- material ingredient reporting
- low emitting materials
- lighting quality
- acoustics

LOCATION DEPENDENT

LIGHTING AND MEP INTEGRATION

AcoustiBuilt® installed on FrameAll™ Drywall Grid offers comparable compatibility to standard drywall and easily accommodates a wide variety of conventional and integrated lighting solutions from Armstrong lighting partners. Additional options include standard industry lighting that complements the module size, or pendant fixtures that hang below the ceiling system.



AcoustiBuilt with Axiom® Direct Light Cove

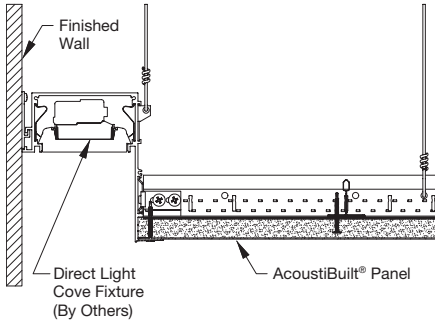

AcoustiBuilt with Axiom Linear Lighting

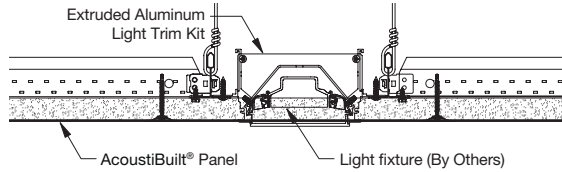

AcoustiBuilt with Trimless Downlighting

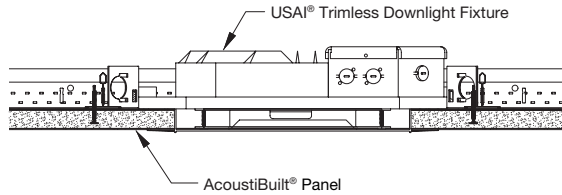

MEP PARTNERS

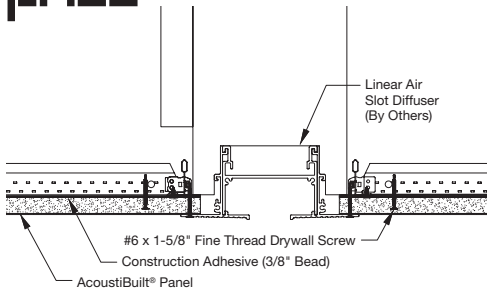

AcoustiBuilt with SimpleSoffit®

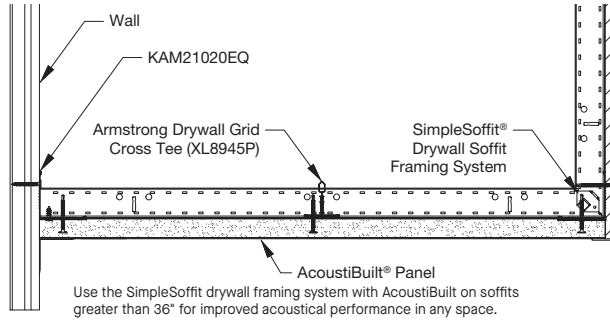

[Download AcoustiBuilt Drawing Details Library >](#)

VIDASHIELD UV24™

	Item No.	Description
VidaShield UV24 Air Purification System	52CHZUVC	VidaShield UV24 Air Purification System for Calla® Health Zone™ (Coordinates with AcoustiBuilt)
	52LUVK	VidaShield UV24 Air Purification System LED Light Panel
Installation Kits	52DACBTK	VidaShield UV24 Drywall/AcoustiBuilt Trim Kit

See VidaShield UV24 Air Purification System data page for complete details.

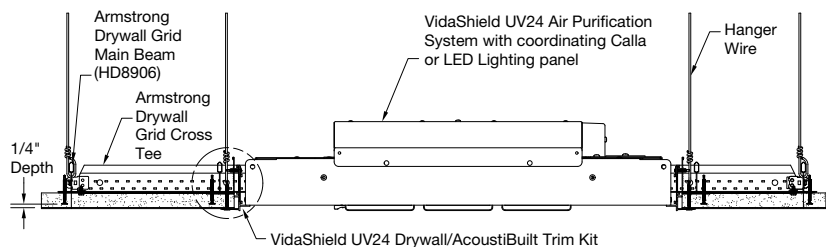

TechLine / 1 877 276-7876
armstrongceilings.com/acoustibuilt
BPCS-5940-524

Axis is owned by Axis Lighting Inc.; XAL is owned by XAL, LLC.; USAI® is a registered trademark of USAI Lighting, LLC; Flexhead® is a registered trademark of Anvil International; Price® is a registered trademark of Price Industries Limited; Titebond® is a trademark of Franklin International; VidaShield UV24 is the property of Medical Illumination International, Inc.; Revit® is a registered of Autodesk, Inc.; all other trademarks used herein are the property of AWI Licensing LLC and/or its affiliates © 2024 AWI Licensing LLC

Armstrong®
World Industries



ACOUSTIBUILT® CEILING AND WALL SYSTEM