

CLEAN ROOM™

15/16" Exposed Tee Suspension System
steel



SUSTAIN™
High Performance
Sustainable
Ceiling Systems



Clean Room suspension system

This suspension system with integral gasket is designed specifically for clean rooms, food processing areas, and data centers.

KEY SELECTION ATTRIBUTES

- Suitable for use in Class 5 (Class 100 clean rooms as defined by ISO Standard 14644-1 (Federal Standard 209E) when used with Clean Room™ FL, Clean Room VL, Ultima® Health Zone™, and Optima® Health Zone™
- Clean Room 15/16" is part of the Sustain™ portfolio and meets the most stringent industry sustainability compliance standards today
- CleanAssure™ family of products – includes disinfectable panels, suspension systems, and trim
- Seismic Rx® Suspension System; ICC-ES approach to installations (ESR-1308)
- Integral gasket for better seal between panel and grid
- Integral main beam splice for easy connections and module control
- XL® staked-on end detail
- Rotary-stitched for additional torsion strength
- 10-year limited warranty; 30-year with HumiGuard® Plus

TYPICAL APPLICATIONS

- Laboratories / Clean Rooms
- Pharmaceutical facilities
- Automotive and aerospace
- Computer rooms
- Hospitals
- Food processing facilities
- High-tech manufacturing
- Data Centers

COLOR



VISUAL SELECTION

Item No.	Description	Rout Spacing	Dimensions (Inches)	HANGER SPACING* LBS/LF			PERFORMANCE					PACKAGING	
				2 Ft.	4 Ft.	5 Ft.	Fire Guard™	Seismic Category	CleanAssure™ Disinfectable Grid	Fog	Spray	Wipe	Pieces/ Carton
ES7901	12' HD Main Beam	12" O.C.	144 × 15/16" × 1-11/16"	N/A	20.39	8.4	N/A	*	*	*	*	20	240
ES7940	4' Cross Tee	12" O.C.	48 × 15/16" × 1-11/16"	N/A	17.26	N/A	N/A	N/A	*	*	*	60	240
ES7920	2' Cross Tee		24 × 15/16" × 1-11/16"	67.4	N/A	N/A	N/A	N/A	*	*	*	60	120
ES7801	12' Hemmed Angle Molding		144 × 15/16" × 15/16"									30	360

* Simple Span

Dots represent high level of performance.

ACCESSORIES

CHDC – Clear Hold Down Clip
Attaches to top bulb of the suspension system to hold 1/16" to 5/8" lay-in panel in place; helps to prevent ceiling panel fluttering at entryways.



CHDC – 50 pcs
FZCHDC – 50 pcs

XTAC – Cross Tee Adapter Clip
Attaches cross tees or main beams to the structural wall molding when supporting heavy loads around the perimeter of the ceiling installation.

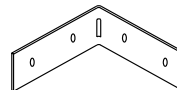

XTAC – 100 pcs
FZXTAC – 50 pcs

BERC2 – 2" Beam End Retaining Clip
Allows you to create a code compliant Seismic D, E, F ceiling installation while eliminating the need to use 2" wall molding or spreader bars.

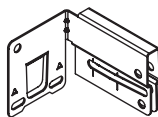

BERC2 (Steel) – 200 pcs
FZBERC2 (Steel) – 50 pcs

BHDC – Border Hold Down Clip
Attaches to Angle Molding to hold down perimeter panels

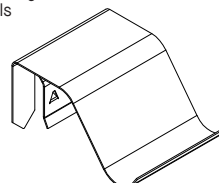

BHDC – 100 pcs

TechLine 877 276-7876

armstrongceilings.com/cleanroomgrid

Armstrong®
World Industries



CLEAN ROOM™

15/16" Exposed Tee Suspension System steel



LEED® WELL | LBC

UP TO 63% RECYCLED CONTENT

Calculate sustainability with Green Genie™ armstrongceilings.com/greengenie

energy management	construction waste mgmt	recycled materials	design for flexibility	EPD	recyclable/repairable producer resp.	biobased materials	recycled content	sourcing of raw materials	material ingredient reporting	low emitting/ materials	lighting quality	acoustics
✓	✓	✓					✓	✓	✓	✓		

LOCATION DEPENDENT

Well Building Standard™ (WELL) Living Building Challenge® (LBC)

MAXIMUM FIXTURE WEIGHT

Item No.	CONFIGURATION	FIXTURE*		PLANNING MODULE		HANGER SPACING		MAXIMUM WEIGHT			
		A	B	A	B	A	B	A	B		
Main Beam to Main Beam ES7901		A	B	24" x 48"	N/A	48" x 48"	N/A	48"	N/A	100.0 lbs.	N/A
		A	B	24" x 48"	12" x 48"	48" x 48"	48" x 48"	48"	48"	70.0 lbs.	100.0 lbs.
		A	B	12" x 48"	N/A	48" x 48"	N/A	48"	N/A	69.0 lbs.	N/A

* Fixtures weighing more than 56 lbs. should be independently supported. Fixture weight is based on single fixture only. For end-to-end fixtures or other configurations not shown, consult your Armstrong representative.

DETAILS

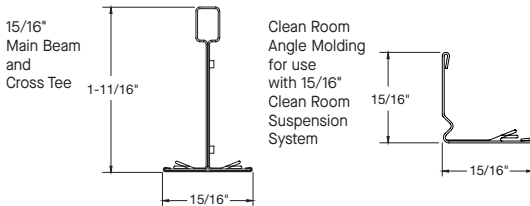

SEISMIC PERFORMANCE

Main Beams – Minimum Lbs. To Pull Out Compression/Tension ES7901 - 294.6
 Cross Tees – Minimum Lbs. To Pull Out Compression/Tension ES7940, ES7920 - 492.40

ICC Reports
 For areas under ICC jurisdiction, see ICC evaluation report number 1308 for allowable values and/or conditions of use concerning the suspension system components listed on this page. The report is subject to re-examination, revisions, and possible cancellation.

PHYSICAL DATA

Material
 Hot-dipped Galvanized Steel – Gasketed
 Surface Finish
 Baked Polyester Paint
 Manufactured and tested in accordance with ASTM C635

Cross Tee/Main Beam Interface
 Flush Fit
 Cleaning and Disinfecting
 Cleaning and CDC recommended disinfecting options available on armstrongceilings.com/cleaning

End Detail
 Main Beam: Integral
 Cross Tee: Staked-on Clip

