

OPTIMA® PB Shapes  
for DESIGNFLEX®  
with Plant-based Binder  
Tegular  
fine texture



## DESIGNFLEX® CEILING SYSTEMS

**PERSONALIZE YOUR DESIGN!**  
Mix and match different sizes, shapes, colors, and materials to reinvent your ceiling. More at: [armstrongceilings.com/designflex](http://armstrongceilings.com/designflex)



Optima® PB Shapes panels with Suprafine® XM 9/16" suspension system

Fine-textured ceiling panels available in shapes and made-to-order sizes with Sustain® performance. Available to ship in 3 weeks.

### KEY SELECTION ATTRIBUTES

- DesignFlex® options include shapes and made-to-order sizes available to ship in 3 weeks
- Mix and match – Shapes also available with Calla®, Lyra®, Ultima®, MetalWorks™, and WoodWorks® panels
- Optima® PB panels are manufactured with a plant-based binder and are part of the Sustain® portfolio, and meet the most stringent industry sustainability compliance standards today
- CleanAssure™ family of products – includes disinfectable panels, suspension systems, and trim
- Mold- and mildew-resistant surface
- Excellent sound absorption – NRC 0.95
- Light reflectance – 0.88
- Shaped lights and diffusers are available from our DesignFlex® partners. Our lighting partners for TechZone® and MEP partners also provide products that are compatible with the DesignFlex® system; other standard modular and pendant fixtures can also be used with this ceiling system
- Washable, Scratch-resistant, Soil-resistant
- 10-Year Limited System Warranty against visible sag, mold, and mildew

### COLOR



White  
(WH)

### DETAILS



1. Optima® PB Shapes Tegular
2. Optima® PB Shapes Tegular with Suprafine® XM 9/16" suspension system

# OPTIMA® PB Shapes for DESIGNFLEX®

with Plant-based Binder  
Tegular  
fine texture

**SUSTAIN\***  
High Performance  
Sustainable Ceiling Systems

**GREENGUARD**  
Gold Certified  
(details below)

**Declare.**

**LEED® WELL | LBC**

**71% RECYCLED CONTENT**

energy management  
construction waste mgmt  
regional materials  
design for flexibility  
EPD  
recyclable/producer resp.

biobased materials  
recycled content  
sourcing of raw materials  
material ingredient reporting  
low emitting materials  
lighting quality  
acoustics

Calculate sustainability with Green Genie®  
armstrongceilings.com/greengenie

LOCATION DEPENDENT

Start your design process with a visit to our online pattern gallery at: [armstrongceilings.com/patterngallery](http://armstrongceilings.com/patterngallery)

See dozens of pre-designed patterns and colors online in our pattern gallery. We've provided all of the details – from takeoffs showing 2' or 4' on-center spacing to panels, suspension, trims, and accessories. Installation instructions answer questions typically associated with unique ceiling installations. Lighting and air diffusers can also be easily integrated. If you can't find the ceiling pattern you envision for your next space online, call us and we'll help you create a design to personalize your space – 1 877 276-7876.



These 9 Optima® PB Shapes with Square Tegular edges are available with Suprafine® XM 9/16" suspension:

## 45° SHAPES

### Triangles

2' Main Beam Spacing

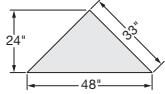

| Item No.         | Description/<br>Dimensions<br>(Inches) |
|------------------|--|
| 100200           | Triangle<br>24 x 48 x 1"               |
| Total Acoustics¹ |  |
| NRC<br>0.95      | CAC<br>N/A                             |

Right Triangle –  
2' Main Beam Spacing



| Item No.         | Description/<br>Dimensions<br>(Inches) |
|------------------|--|
| 100207           | Right Triangle –<br>24 x 24 x 1"       |
| Total Acoustics¹ |  |
| NRC<br>0.95      | CAC<br>N/A                             |

Right Triangle –  
4' Main Beam Spacing

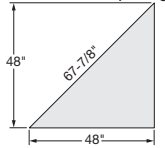

| Item No.         | Description/<br>Dimensions<br>(Inches) |
|------------------|--|
| 100208           | Right Triangle –<br>48 x 48 x 1"       |
| Total Acoustics¹ |  |
| NRC<br>0.95      | CAC<br>N/A                             |

## 60° SHAPES

### Triangles

2' Main Beam Spacing

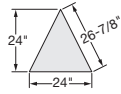

| Item No.         | Description/<br>Dimensions<br>(Inches) |
|------------------|--|
| 100201           | Triangle<br>24 x 24 x 1"               |
| Total Acoustics¹ |  |
| NRC<br>0.95      | CAC<br>N/A                             |

4' Main Beam Spacing

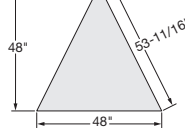

| Item No.         | Description/<br>Dimensions<br>(Inches) |
|------------------|--|
| 100202           | Triangle<br>48 x 48 x 1"               |
| Total Acoustics¹ |  |
| NRC<br>0.95      | CAC<br>N/A                             |

Right Triangle –  
2' Main Beam Spacing

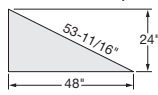

| Item No.         | Description/<br>Dimensions<br>(Inches) |
|------------------|--|
| 100205           | Right Triangle –<br>Left 24 x 48 x 1"  |
| Total Acoustics¹ |  |
| NRC<br>0.95      | CAC<br>N/A                             |

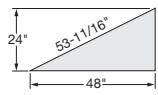

| Item No.         | Description/<br>Dimensions<br>(Inches) |
|------------------|--|
| 100206           | Right Triangle –<br>Right 24 x 48 x 1" |
| Total Acoustics¹ |  |
| NRC<br>0.95      | CAC<br>N/A                             |

## 75° SHAPES

### Triangles

2' Main Beam Spacing

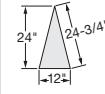

| Item No.         | Description/<br>Dimensions<br>(Inches) |
|------------------|--|
| 100203           | Triangle<br>24 x 12 x 1"               |
| Total Acoustics¹ |  |
| NRC<br>0.95      | CAC<br>N/A                             |

4' Main Beam Spacing

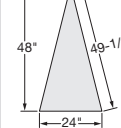

| Item No.         | Description/<br>Dimensions<br>(Inches) |
|------------------|--|
| 100204           | Triangle<br>48 x 24 x 1"               |
| Total Acoustics¹ |  |
| NRC<br>0.95      | CAC<br>N/A                             |

**MORE ITEMS** ▶

¹ Total Acoustics® ceiling panels have an ideal combination of sound absorption and sound blocking in one product.  
**GOOD** (NRC 0.60-0.65; CAC 35+) **BETTER** (NRC 0.70-0.75; CAC 35+) **BEST** (NRC 0.80+; CAC 35+)

## SUSPENSION SYSTEMS

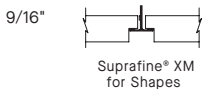

## PARTNER COMPANIES

For more information on our partner companies, please visit [armstrongceilings.com/partners](http://armstrongceilings.com/partners)

Compatible with:  
Axis Geometrix™ Lighting,  
JLC-Tech T-BAR FLEX LED  
Lights and Price diffusers.



Shaped infill panels are available for applicable lighting fixtures. Add **L I N E** to the end of any Shape panel item number to order. Metal diffuser infills are available from the diffuser manufacturer.

## PHYSICAL DATA

**Material**  
Fiberglass with DuraBrite® acoustically transparent membrane

**Surface Finish**  
DuraBrite with factory-applied latex paint

**Fire Performance**  
Class A: ASTM E84 and CAN/ULC S102 surface burning characteristics. Flame Spread Index 25 or less. Smoke Developed Index 50 or less (UL labeled).

**ASTM E1264 Classification**  
Type XII, Form 2, Pattern E; Fire Class A

**Humidity/Sag Resistance**  
HumiGuard® Plus ceiling panels are recommended for areas subject to high humidity, up to, but not including, standing water and outdoor applications.

**Anti-Mold/Mildew**  
Ceiling tiles with BioBlock® performance resist the growth of mold and mildew on the tile surface.

**VOC Emissions**  
GREENGUARD Gold Certified  
Third-party certified compliant with California Department of Public Health CDPH/EHLB/Standard Method Version 1.2, 2017. This standard is the guideline for low emissions in LEED®, WELL Building Standard®, Living Building Challenge® (LBC), CalGreen Title 24, ANSI/ASHRAE/USGBC/IES Standard 189; ANSI/GBI Green Building Assessment Protocol



**High Recycled Content**  
Classified as containing greater than 50% total recycled content. Total recycled content based on product composition of post-consumer and pre-consumer (post-industrial) recycled content per FTC guidelines.

**Seismic Restraint**  
Suprafine® XM for Shapes suspension systems have been engineered, tested, and approved for use with DesignFlex®

Shapes panels for application in all seismic areas when installed per Armstrong® Ceilings installation instructions. For more details, visit [armstrongceilings.com/shapesinstallation](http://armstrongceilings.com/shapesinstallation)

**Insulation Value**  
R Factor – 2.2 (BTU units); R Factor – 0.39 (Watts units)

**Cleaning and Disinfecting**  
Cleaning and CDC recommended disinfecting options available on [armstrongceilings.com/cleaning](http://armstrongceilings.com/cleaning)

**10-Year Performance Guarantee & Warranty**  
When installed with Armstrong® Suspension System. Details at [armstrongceilings.com/warranty](http://armstrongceilings.com/warranty)

| Weight; Pieces/Carton           | Item No.                                |
|---------------------------------|---|
| 100203 – 0.4 lbs/pc; 24 pcs/ctn | 100200, 100204 – 1.6 lbs/pc; 12 pcs/ctn |
| 100201 – 0.8 lbs/pc; 12 pcs/ctn | 100205, 100206 – 1.6 lbs/pc; 24 pcs/ctn |
| 100207 – 0.8 lbs/pc; 24 pcs/ctn | 100208 – 3.2 lbs/pc; 12 pcs/ctn         |
| 100208 – 3.2 lbs/pc; 12 pcs/ctn | 100202 – 3.2 lbs/pc; 6 pcs/ctn          |

**Minimum Order Quantity**  
1 carton

TechLine 877 276-7876  
[armstrongceilings.com/optimashapes](http://armstrongceilings.com/optimashapes)

**Armstrong®**  
World Industries



DESIGNFLEX® SHAPES

# OPTIMA® PB Shapes for DESIGNFLEX®

with Plant-based Binder  
Tegular  
fine texture

**SUSTAIN®**  
High Performance  
Sustainable Ceiling Systems

**GREENGUARD**  
Gold Certified  
(details below)

**LEED® WELL™ LBC**

71% RECYCLED CONTENT

energy management  
construction waste mgmt  
regional materials  
design for flexibility  
EPD  
recyclable/extended producer resp.  
biobased materials  
recycled content  
sourcing of raw materials  
material ingredient reporting  
low emitting materials  
lighting quality  
acoustics

Calculate sustainability with Green Genie™  
armstrongceilings.com/greengenie

**Declare.**

LOCATION DEPENDENT

PANEL OPTIONS (shown in finish view from below ceiling)

These 10 Optima® PB Shapes with Square Tegular edges are available with Suprafine® XM 9/16" suspension:

## 45° SHAPES

### Parallelograms

2' Main Beam Spacing

Item No. **100213** Description/Dimensions (Inches)  
Right Parallelogram 24 x 48 x 1"

Total Acoustics¹

NRC + CAC = NRC/CAC

0.95 N/A -

Item No. **100214** Description/Dimensions (Inches)  
Left Parallelogram 24 x 48 x 1"

Total Acoustics¹

NRC + CAC = NRC/CAC

0.95 N/A -

## 60° SHAPES

### Parallelograms

2' Main Beam Spacing

Item No. **100215** Description/Dimensions (Inches)  
Right Parallelogram 24 x 24 x 1"

Total Acoustics¹

NRC + CAC = NRC/CAC

0.95 N/A -

Item No. **100216** Description/Dimensions (Inches)  
Left Parallelogram 24 x 24 x 1"

Total Acoustics¹

NRC + CAC = NRC/CAC

0.95 N/A -

Item No. **100217** Description/Dimensions (Inches)  
Right Parallelogram 48 x 48 x 1"

Total Acoustics¹

NRC + CAC = NRC/CAC

0.95 N/A -

Item No. **100218** Description/Dimensions (Inches)  
Left Parallelogram 48 x 48 x 1"

Total Acoustics¹

NRC + CAC = NRC/CAC

0.95 N/A -

## 75° SHAPES

### Parallelograms

2' Main Beam Spacing

Item No. **100219** Description/Dimensions (Inches)  
Right Parallelogram 24 x 12 x 1"

Total Acoustics¹

NRC + CAC = NRC/CAC

0.95 N/A -

Item No. **100220** Description/Dimensions (Inches)  
Left Parallelogram 24 x 12 x 1"

Total Acoustics¹

NRC + CAC = NRC/CAC

0.95 N/A -

Item No. **100221** Description/Dimensions (Inches)  
Right Parallelogram 48 x 24 x 1"

Total Acoustics¹

NRC + CAC = NRC/CAC

0.95 N/A -

Item No. **100222** Description/Dimensions (Inches)  
Left Parallelogram 48 x 24 x 1"

Total Acoustics¹

NRC + CAC = NRC/CAC

0.95 N/A -

¹ Total Acoustics® ceiling panels have an ideal combination of sound absorption and sound blocking in one product.  
GOOD (NRC 0.60-0.65; CAC 35+) BETTER (NRC 0.70-0.75; CAC 35+) BEST (NRC 0.80+; CAC 35+)

## SUSPENSION SYSTEMS

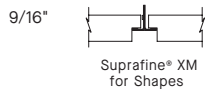

## PARTNER COMPANIES

For more information on our partner companies, please visit [armstrongceilings.com/partners](http://armstrongceilings.com/partners)

Compatible with:  
Axis Geometrix™ Lighting,  
JLC-Tech T-BAR FLEX LED  
Lights and Price diffusers.



Shaped infill panels are available for applicable lighting fixtures. Add **L I N E** to the end of any Shape panel item number to order. Metal diffuser inflills are available from the diffuser manufacturer.

## PHYSICAL DATA

**Material**  
Fiberglass with DuraBrite® acoustically transparent membrane

**Surface Finish**  
DuraBrite with factory-applied latex paint

**Fire Performance**  
Class A: ASTM E84 and CAN/ULC S102 surface burning characteristics. Flame Spread Index 25 or less. Smoke Developed Index 50 or less (UL labeled).

**ASTM E1264 Classification**  
Type XII, Form 2, Pattern E; Fire Class A

**Humidity/Sag Resistance**  
HumiGuard® Plus ceiling panels are recommended for areas subject to high humidity, up to, but not including, standing water and outdoor applications.

**Anti-Mold/Mildew**  
Ceiling tiles with BioBlock® performance resist the growth of mold and mildew on the tile surface.

**VOC Emissions**  
GREENGUARD Gold Certified  
Third-party certified compliant with California Department of Public Health CDPH/EHLB/Standard Method Version 1.2, 2017. This standard is the guideline for low emissions in LEED®, WELL Building Standard®, Living Building Challenge® (LBC), CalGreen Title 24, ANSI/ASHRAE/USGBC/IES Standard 189; ANSI/GBI Green Building Assessment Protocol

**High Recycled Content**  
Classified as containing greater than 50% total recycled content. Total recycled content based on product composition of post-consumer and pre-consumer (post-industrial) recycled content per FTC guidelines.

**Seismic Restraint**  
Suprafine® XM for Shapes suspension systems have been engineered, tested, and approved for use with DesignFlex® Shapes panels for application in all seismic areas when installed per Armstrong® Ceilings installation instructions. For more details, visit [armstrongceilings.com/shapesinstallation](http://armstrongceilings.com/shapesinstallation)

PRODUCT CERTIFIED FOR LOW CHEMICAL EMISSIONS  
UL.COM/GG UL 2818



**Insulation Value**  
R Factor - 2.2 (BTU units)  
R Factor - 0.39 (Watts units)

**Cleaning and Disinfecting**  
Cleaning and CDC recommended disinfecting options available on [armstrongceilings.com/cleaning](http://armstrongceilings.com/cleaning)

**10-Year Performance Guarantee & Warranty**  
When installed with Armstrong® Suspension System. Details at [armstrongceilings.com/warranty](http://armstrongceilings.com/warranty)

**Weight; Pieces/Carton**  
100219, 100220 - 0.8 lbs/pc; 24 pcs/ctn  
100215, 100216 - 1.6 lbs/pc; 12 pcs/ctn  
100213, 100214, 100221, 100222 - 3.2 lbs/pc; 12 pcs/ctn  
100217, 100218 - 6.4 lbs/pc; 6 pcs/ctn

**Minimum Order Quantity**  
1 carton

# OPTIMA® PB Shapes for DESIGNFLEX®

with Plant-based Binder  
Tegular  
fine texture

**SUSTAIN\***  
High Performance  
Sustainable Ceiling Systems

**GREENGUARD**  
Gold Certified  
(details below)

**Declare.**

**LEED® WELL™ LBC**

**71% RECYCLED CONTENT**

Calculate sustainability with Green Genie®  
armstrongceilings.com/greengenie

|                   |                         |                    |                        |     |                           |                    |                  |                           |                               |                        |                  |           |
|-------------------|-------------------------|--------------------|------------------------|-----|---------------------------|--------------------|------------------|---------------------------|-------------------------------|------------------------|------------------|-----------|
| energy management | construction waste mgmt | regional materials | design for flexibility | EPD | recyclable/producer resp. | biobased materials | recycled content | sourcing of raw materials | material ingredient reporting | low emitting materials | lighting quality | acoustics |
|-------------------|-------------------------|--------------------|------------------------|-----|---------------------------|--------------------|------------------|---------------------------|-------------------------------|------------------------|------------------|-----------|

LOCATION DEPENDENT

## PANEL OPTIONS (shown in finish view from below ceiling)

These 4 Optima® PB Shapes with Square Tegular edges are available with Suprafine® XM 9/16" suspension:

### 45° SHAPES

#### Trapezoids

2' Main Beam Spacing

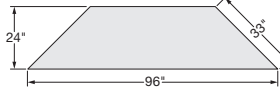

| Item No. | Description/Dimensions (Inches) |
|----------|---------------------------------|
| 100209   | Trapezoid 24 x 96 x 1"          |

Total Acoustics<sup>1</sup>

$$\text{NRC} + \text{CAC} = \text{NRC} + \text{CAC}$$

0.95    N/A    -

### 60° SHAPES

#### Trapezoids

2' Main Beam Spacing

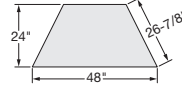

| Item No. | Description/Dimensions (Inches) |
|----------|---------------------------------|
| 100210   | Trapezoid 24 x 48 x 1"          |

Total Acoustics<sup>1</sup>

$$\text{NRC} + \text{CAC} = \text{NRC} + \text{CAC}$$

0.95    N/A    -

### 75° SHAPES

#### Trapezoids

2' Main Beam Spacing

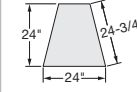

| Item No. | Description/Dimensions (Inches) |
|----------|---------------------------------|
| 100211   | Trapezoid 24 x 24 x 1"          |

Total Acoustics<sup>1</sup>

$$\text{NRC} + \text{CAC} = \text{NRC} + \text{CAC}$$

0.95    N/A    -

4' Main Beam Spacing

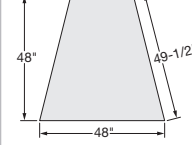

| Item No. | Description/Dimensions (Inches) |
|----------|---------------------------------|
| 100212   | Trapezoid 48 x 48 x 1"          |

Total Acoustics<sup>1</sup>

$$\text{NRC} + \text{CAC} = \text{NRC} + \text{CAC}$$

0.95    N/A    -

<sup>1</sup> Total Acoustics® ceiling panels have an ideal combination of sound absorption and sound blocking in one product. **GOOD** (NRC 0.60-0.65; CAC 35+) **BETTER** (NRC 0.70-0.75; CAC 35+) **BEST** (NRC 0.80+; CAC 35+)

## SUSPENSION COMPONENTS System utilizes Suprafine® XM suspension components including angle brackets, corner brackets, main beams, cross tees and perimeter clips.



Right Angle Bracket

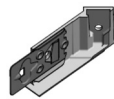

Left Angle Bracket



Double Angle Bracket



Corner Bracket

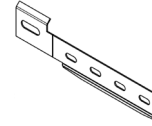

Axiom® perimeter corner clip

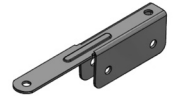

Perimeter angle clip

## SUSPENSION SYSTEMS

9/16"



Suprafine® XM for Shapes

## PARTNER COMPANIES

For more information on our partner companies, please visit [armstrongceilings.com/partners](http://armstrongceilings.com/partners)

Compatible with:  
Axis Geometrix™ Lighting,  
JLC-Tech T-BAR FLEX LED  
Lights and Price diffusers.



Shaped infill panels are available for applicable lighting fixtures. Add **L I N E** to the end of any Shape panel item number to order. Metal diffuser infills are available from the diffuser manufacturer.

## PHYSICAL DATA

**Material**  
Fiberglass with DuraBrite® acoustically transparent membrane

**Surface Finish**  
DuraBrite with factory-applied latex paint

**Fire Performance**  
Class A: ASTM E84 and CAN/ULC S102 surface burning characteristics. Flame Spread Index 25 or less. Smoke Developed Index 50 or less (UL labeled).

**ASTM E1264 Classification**  
Type XII, Form 2, Pattern E; Fire Class A

**Humidity/Sag Resistance**  
HumiGuard® Plus ceiling panels are recommended for areas subject to high humidity, up to, but not including, standing water and outdoor applications.

**Anti-Mold/Mildew**  
Ceiling tiles with BioBlock® performance resist the growth of mold and mildew on the tile surface.

**VOC Emissions**  
GREENGUARD Gold Certified  
Third-party certified compliant with California Department of Public Health CDPH/EHLB/Standard Method Version 1.2, 2017. This standard is the guideline for low emissions in LEED®, WELL Building Standard®, Living Building Challenge® (LBC), CalGreen Title 24, ANSI/ASHRAE/USGBC/IES Standard 189; ANSI/GBI Green Building Assessment Protocol

**High Recycled Content**  
Classified as containing greater than 50% total recycled content. Total recycled content based on product composition of post-consumer and pre-consumer (post-industrial) recycled content per FTC guidelines.

**Seismic Restraint**  
Suprafine® XM for Shapes suspension systems have been engineered, tested, and approved for use with DesignFlex® Shapes panels for application in all seismic areas when installed per Armstrong® Ceilings installation instructions. For more details, visit [armstrongceilings.com/shapesinstallation](http://armstrongceilings.com/shapesinstallation)

**PRODUCT CERTIFIED FOR LOW CHEMICAL EMISSIONS**  
UL.COM/GG  
UL 2818



**Insulation Value**  
R Factor – 2.2 (BTU units)  
R Factor – 0.39 (Watts units)

**Cleaning and Disinfecting**  
Cleaning and CDC recommended disinfecting options available on [armstrongceilings.com/cleaning](http://armstrongceilings.com/cleaning)

**10-Year Performance Guarantee & Warranty**  
When installed with Armstrong® Suspension System. Details at [armstrongceilings.com/warranty](http://armstrongceilings.com/warranty)

**Weight; Pieces/ Carton**  
100211 – 1.2 lbs/pc; 12 pcs/ctn  
100210 – 2.4 lbs/pc; 12 pcs/ctn  
100209, 100212 – 4.8 lbs/pc; 6 pcs/ctn

**Minimum Order Quantity**  
1 carton