

# METALWORKS™ Linear – Synchro®

Standard Wall Planks



MetalWorks™ Linear – Synchro® 6" planks in Tech Black

CAD/Revit® drawings at:  
[armstrongceilings.com/cadrevit](http://armstrongceilings.com/cadrevit)

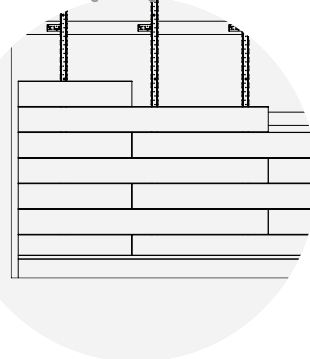

plus capabilities  
to do more

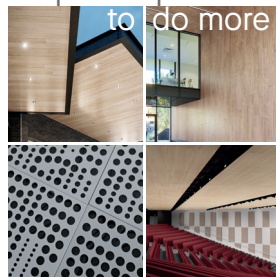

[armstrongceilings.com/capabilities](http://armstrongceilings.com/capabilities)  
See more photos at:  
[armstrongceilings.com/photogallery](http://armstrongceilings.com/photogallery)

Durable, metal wall planks install in both horizontal and vertical orientations for design flexibility and contribute to healthy spaces for interiors

## KEY SELECTION ATTRIBUTES

**new**

- Install 4", 6", & 9" wide Linear – Synchro® planks on interior wall applications horizontally or vertically with no additional clips or brackets needed
- Achieve high sound absorption for increased acoustical performance with microperforated planks – 0.70 NRC
- Planks easily snap into upper hooks of new Main Beam Carrier 2 (item 7277MF)
- CleanAssure™ family of products – includes disinfectable planks, suspension systems, and trim
- Linear - Synchro wall planks are available in 4 standard metal finishes and 17 Effects™ wood-look finish options
- Smooth monolithic visual with durable metal planks – perfect for high traffic areas

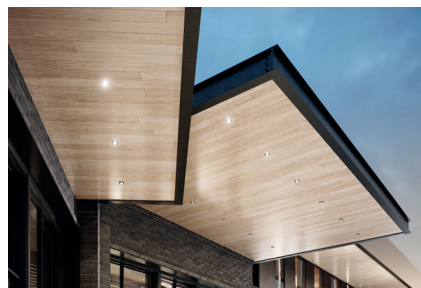

*Also Available for Ceilings!*

TechLine 877 276-7876  
[armstrongceilings.com/metalwalls](http://armstrongceilings.com/metalwalls)

**Armstrong®**  
World Industries

# METALWORKS™ Linear – Synchro®

## Standard Wall Planks

**LEED® WELL | LBC**

**58% RECYCLED CONTENT**

For LEED contribution contact TechLine

- energy management
- construction waste mgmt
- regional materials
- design for flexibility
- EPD
- recyclable/producer resp.
- biobased materials
- recycled content
- sourcing of raw materials
- material ingredient reporting
- low emitting materials
- lighting quality
- acoustics

LOCATION DEPENDENT

WHITE ONLY WITH INFILL PANEL



MetalWorks™ Linear - Synchro® 4", 6", 9" planks in Effects™ Macadamia

### STANDARD COLORS & FINISHES

Due to printing limitations, shade may vary from actual product.

MetalWorks™ (Interior only)

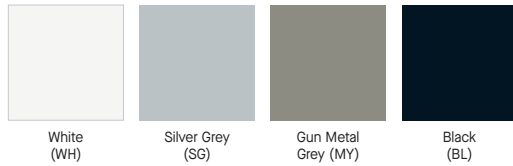

#### Effects™ Classic Dye-Sublimation



#### Effects™ Bold Dye-Sublimation



#### Effects™ Subtle Dye-Sublimation



### CUSTOM COLORS & FINISHES

Due to printing limitations, shade may vary from actual product.



For custom options contact ASQuote, ASQuote@armstrongceilings.com

### PERFORATION OPTIONS

(1:2 scale shown)

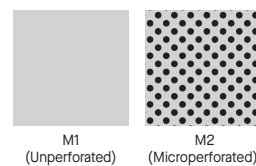

# METALWORKS™ Linear – Synchro® Standard Wall Planks

**LEED WELL LBC** 58% RECYCLED CONTENT

For LEED contribution contact TechLine

- energy management
- construction waste mgmt
- regional materials
- design for flexibility
- EPD
- recyclable/extended producer resp.
- biobased materials
- recycled content
- sourcing of raw materials
- material ingredient reporting
- low emitting materials
- lighting quality
- acoustics

LOCATION DEPENDENT

WHITE ONLY WITH INFILL PANEL

## VISUAL SELECTION

Item No. ♦	Description	Dimensions Nominal W x L x D (Inches) Custom Sizes Available	Module Width (Inches)
8223W04	4" Plank	4 × 96 × 1"	4.50"
8223W06	6" Plank	6 × 96 × 1"	6.75"
8223W09	9" Plank	9 × 96 × 1"	9.00"

## PERFORMANCE

Dots represent high level of performance.

Fire Performance	Light Reflect (M1 White only)	CleanAssure™ Disinfectable Planks			DURABILITY					Acoustics (M2 Perf only)
		Fog	Spray	Wipe	Wash	Scrub	Impact	Scratch	Soil	
Class A	0.83	*	*	*	*	*	*	*	*	0.70
Class A	0.83	*	*	*	*	*	*	*	*	0.70
Class A	0.83	*	*	*	*	*	*	*	*	0.70

♦ When specifying or ordering, include the appropriate 2-letter perforation suffix and 2- or 4-letter color suffix (e.g., 8223W04 M1 E X C H, 8223W09 M2 S G).

## ACCESSORIES

Item No. ♦	Description	Finish Selection - Interior	Pieces/ Carton
8161	Pressure Spring	N/A	50
8233W04M1	4" End Cap	WH, SG, MY, BL, and all Effects™ Wood Looks	10
8233W06M1	6" End Cap	WH, SG, MY, BL, and all Effects Wood Looks	10
8233W09M1	9" End Cap	WH, SG, MY, BL, and all Effects Wood Looks	10
8243W02	2" Splice Plate	N/A	10
8243W04	4" Splice Plate	N/A	10
8243W06	6" Splice Plate	N/A	10
7113	Spreader Hold Down	N/A	40
GSUTC	Rigid Attachment Clip	N/A	150
7237S3	Synchro Cut Plank Bracket	N/A	25
BERC2	BERC2 Clip	BL	200
XTACAG	XTAC Clip	BL	200
GCWA	GCWA Clip	BL	250

♦ When specifying or ordering, include the appropriate 2- or 4-letter color suffix (e.g., 8233W04M1 S G, 8233W04M1 E X C H).



PARTITIONS & WALLS

# METALWORKS™ Linear – Synchro® Standard Wall Planks

**LEED® WELL | LBC**

**58% RECYCLED CONTENT**

For LEED contribution contact TechLine

- energy management
- construction waste mgmt
- regional materials
- design for flexibility
- EPD
- recyclable/repurposed producer resp.
- biobased materials
- recycled content
- sourcing of raw materials
- material ingredient reporting
- low emitting materials
- lighting quality
- acoustics

LOCATION DEPENDENT

WHITE ONLY WITH INFILL PANEL

## SUSPENSION SYSTEM COMPONENTS

Item No. ♦	Description	Dimensions Nominal L x W x H (Inches)	Pieces/ Carton	Color
7277MF	Main Beam Carrier 2 (MBC2) – Mill Finish	144 × 1-3/4 × 2-3/4"	10	N/A
5574_ _ _ _	Carrier Molding	120 × 1 × 1"	10	N/A
7800_ _ _ _	Hemmed Angle Molding	144 × 7/8 × 7/8"	30	WH, BL
XL8926	2' Drywall Cross Tee	24 × 1-1/2 × 1-1/2"	36	BL

♦ When specifying or ordering, include the appropriate 2- or 4-letter color suffix (e.g., 7800 M Y, 5574 E X C H).

## INSTALLATION DETAILS – WALLS

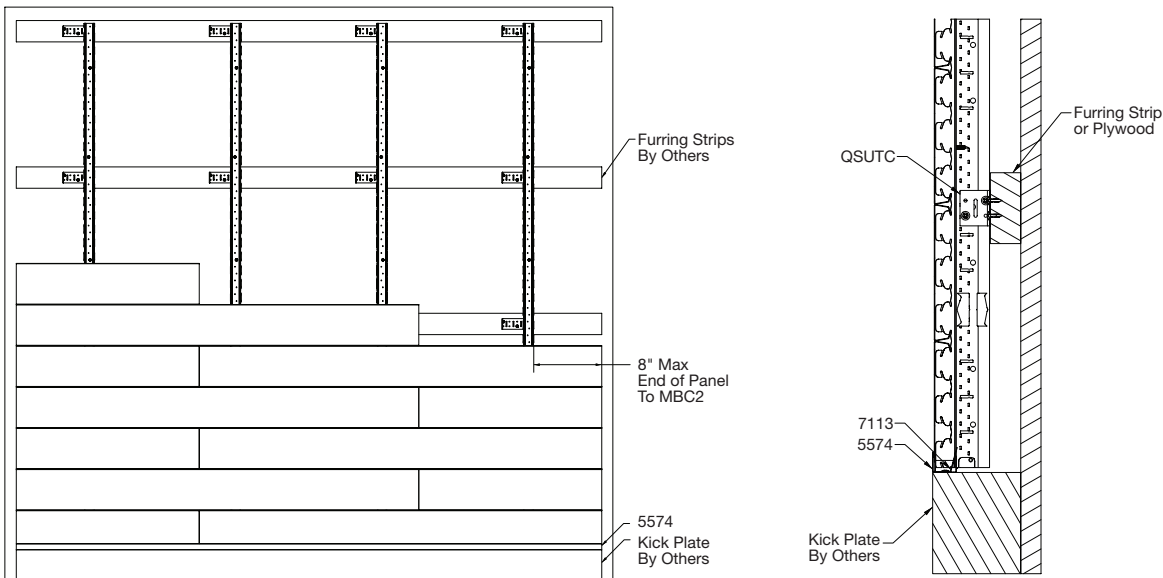

Main Beam Carrier 2 (MBC2) installs on the wall perpendicular to desired plank length direction

Install QSUTC to furring strips or 5/8\"/>

## PHYSICAL DATA

**Material**  
Electrogalvanized Steel – thickness 0.028"

**Surface Finish**  
Available in White, Silver Grey, Gun Metal Grey, Tech Black, and Effects™ Wood Looks powder-coated, post-production finishes. Custom colors are also available, contact ASQuote@armstrongceilings.com for custom requests.

**Plank Reveal**  
MetalWorks Linear – Synchro planks have a butt joint installation with no reveal between planks for a monolithic visual.

**Fire Performance**  
Class A: ASTM E84 and CAN/ULC S102. Flame Spread Index 25 or less. Smoke Developed Index 50 or less.

**ASTM E1264 Classification**  
Fire Class – Class A  
Unperforated – Type XX, Form 2, Pattern G  
Perforated – Type XX, Form 2, Pattern C

**Seismic Restraint**  
MetalWorks Linear – Synchro planks have been engineered, tested, and approved for application in all seismic areas when installed per Armstrong Ceilings installation instructions.  
When installed properly, both planks and suspension have been tested to stay in place through vibrations and other seismic events.

**Cleaning and Disinfecting**  
Cleaning and CDC approved disinfecting options available on [armstrongceilings.com/cleaning](http://armstrongceilings.com/cleaning)

**Warranty**  
Details at [armstrongceilings.com/warranty](http://armstrongceilings.com/warranty)

**Weight; Pcs and SF/Carton**  
8223W04 – 4.45 lbs/pc; 12 pcs/ctn; 36 SF/ctn  
8223W06 – 6.05 lbs/pc; 8 pcs/ctn; 36 SF/ctn  
8223W09 – 7.95 lbs/pc; 6 pcs/ctn; 36 SF/ctn

