

Wall Reveals

Assembly and Installation Instructions

1. GENERAL

1.1 Product Description

Wall reveals create an aesthetic division between drywall panels on vertical walls and ceilings. Reveals can be used to create horizontal or vertical lines and can intersect cleanly where desired. Wall reveals are made of .050" thick 6063 T5 Aluminum with a mill finish and are available in 10' lengths. Custom finishes and lengths available upon request. All Reveals come with alignment splices to ease the installation process and create crisp and clean butt joints and lines. Also available are factory welded corners and intersections upon request (*Fig 1*).

2. COMPONENT ASSEMBLY

2.1 Splice Plates

Steel splice plates are used to align joint between straight sections of reveals and between straight sections and corners or intersections. Simply push the splice into the channel and the friction fit will hold it in place until attachment to wall (*Fig 2*). Ensure the bead of the splice plate faces towards the extrusion. If more holding pressure is desired, apply pressure to each leg of the splice plate to increase leg bow. Splice plates can also be bent 90 degrees for field fabricated intersections.

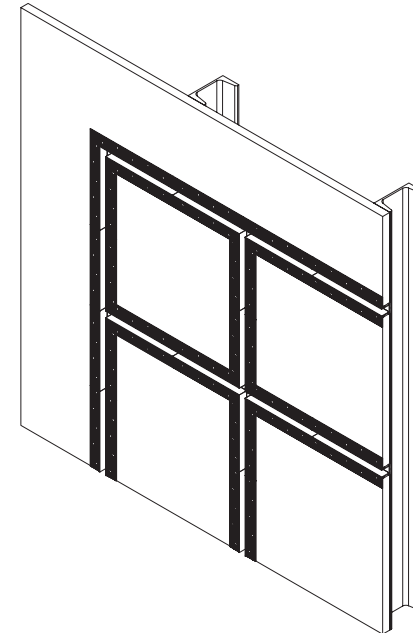

(Fig 1)

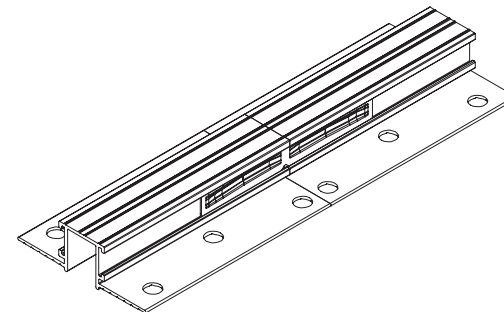

(Fig 2)

2.2 Factory-welded Corners

Inside and outside corners are factory welded sections of molding that measure 6" from the center point of the reveal (custom lengths available upon request). The unmitered ends are attached to the straight sections of molding using the AXRMSPLICE friction fit splice plates. Ensure the bead of the splice plate faces towards the extrusion (Fig 3).

2.3 Factory-welded Intersections

Inside, outside, three-way, four-way, and T intersections are factory welded sections of molding that measure 6" from the center point of the reveal (custom lengths available upon request). The unmitered ends are attached to the straight sections of molding using the AXRMSPLICE friction fit splice plates. Ensure the bead of the splice plate faces towards the extrusion (Fig 4, 5, and 6).

3. GENERAL INSTALLATION INSTRUCTIONS

3.1 All Shapes

3.1.1 Wipe metal with dry cloth or thinner to remove dust, dirt, or oils picked up in transit, handing, or installation prior to taping, mudding, and painting.

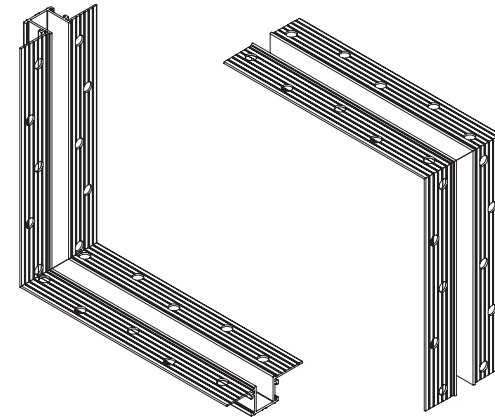

(Fig 3)

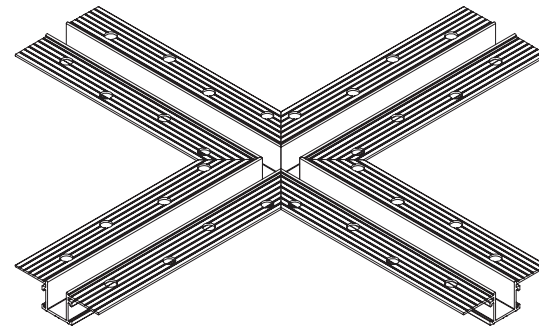

(Fig 4)

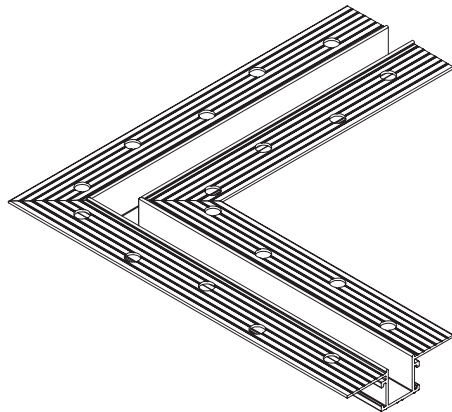

(Fig 6)

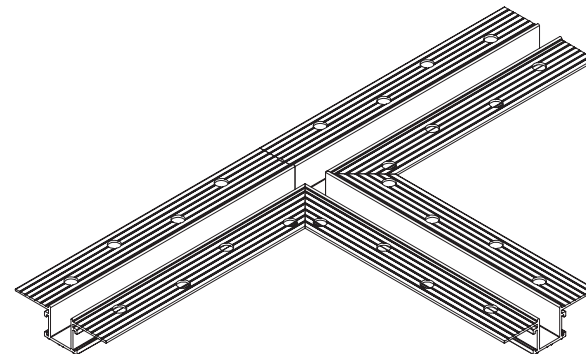

(Fig 5)

3.2 Tapable Flange Shapes

3.2.1 The moldings are generally routed into place after the gypsum board has been installed, but the installer can provide space for the moldings at the time of installation if desired (*Fig 7*).

3.2.2 The framer should provide backing so that moldings may be attached with #6 drywall screws 8 – 24" O.C. Butt joints should be fastened within 3" of ends.

3.2.3 All reveals must be cut accurately and installed with tight, neat joints.

3.2.4 Prior to taping, the attachment flanges should be cleaned using a nonabrasive cleaner and soft rag.

3.2.5 Make sure the tape does not overlap the edge of the reveal and an 8" wide trowel is used to apply the final skim coat

3.2.6 Fiberglass self-adhesive drywall tape will cut taping time and help to avoid possible cracking.

3.3 Non-Tapable Flange Shapes

3.3.1 These types are installed prior to drywall installation and generally do not require taping or spackling (*Fig 8*).

3.4 CUTTING

3.4.1 Materials can be cut with a chop saw, using a 96-tooth blade for non-ferrous metal.

3.4.2 Use a lubricant (WD-40 or grease stick) on the blade prior to cutting. Do not use an abrasive cut-off wheel.

3.4.3 Be sure to clean lubricant off trim.

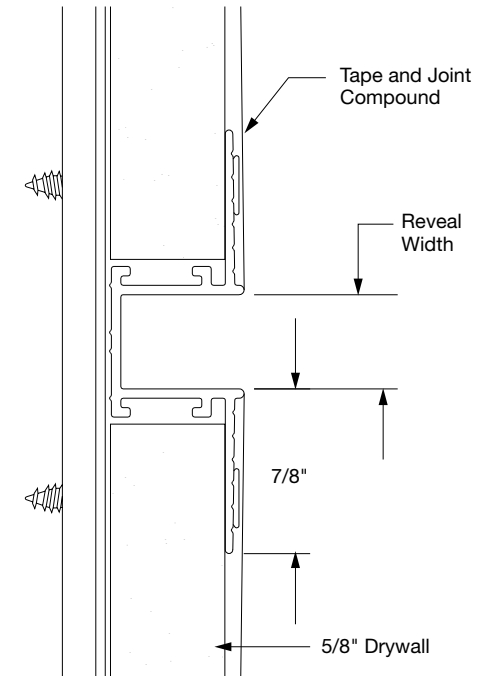

(Fig 7)

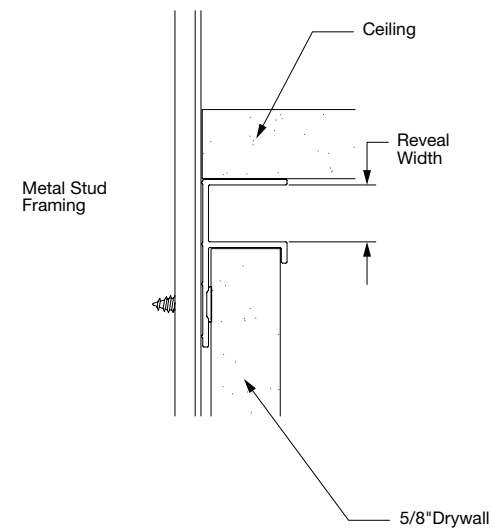

(Fig 8)

3.5 Field Fabricated Intersections

3.5.1 For field fabrication, the AXRMSPLICE can be used to align intersections by bending the splice plate 90 degrees with the beads facing outward. For the inside splice plate, install as normal. For the outside splice plate (if applicable), install with the beads facing away from the extrusion (*Fig 9*).

3.6 Field Painting

Apply paint or wall covering to manufacturers' instructions. Trim has a mill finish, and primer is recommended.

3.7 Final Detailing

3.7.1 Check and adjust the alignment of components.

3.7.2 Clean surfaces as required.

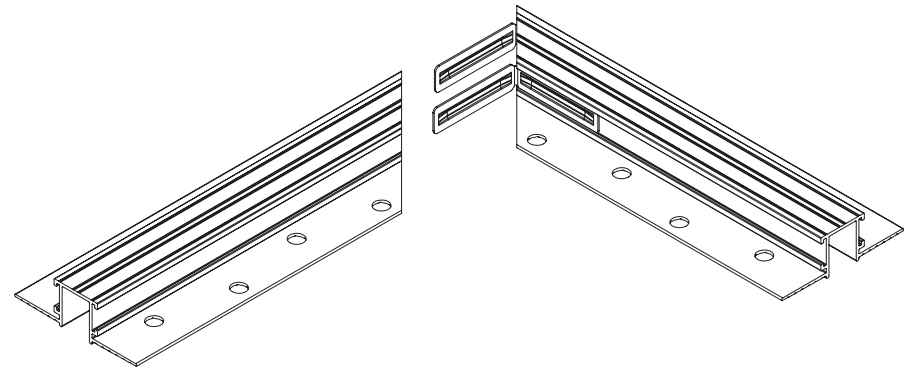

(Fig 9)

MORE INFORMATION

For more information, or for an Armstrong Ceilings representative, call 1 877 276 7876.

For complete technical information, detail drawings, CAD design assistance, installation information, and many other technical services, call TechLine customer support at 1 877 276 7876 or FAX 1 800 572 TECH.

All trademarks used herein are the property of AWI Licensing LLC and/or its affiliates.